

LEPCOS (North-West Laboratory)
<http://ferrite.ru> Tel/fax +7-812-369-11-54
 St-Petesburg, Russia

REVISIONS				
REV	SYM	DRAFTER	CHECKER	DATE
△		T.S.LII	W.H.HSU	11/21/01
△		T.S.LII	W.H.HSU	09/14/04
△				

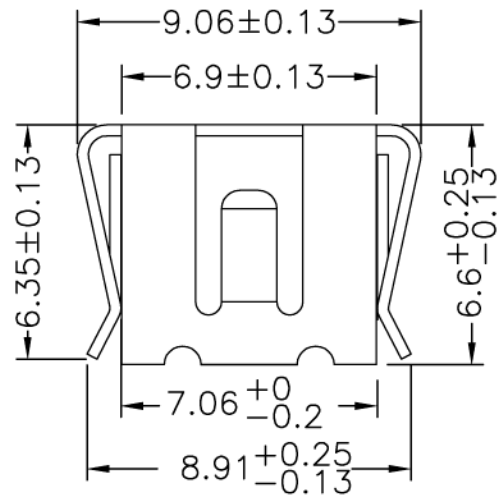

PART NO.	EP7-SMD-CLIP				
DWG NO.	MATERIAL (CLIP)	MATERIAL (TERMINAL)	TERMINAL (PLATING)	PIN ALOCATION	BUYER 'S PART NO.
TBI-403-08031.1	SUS 301				

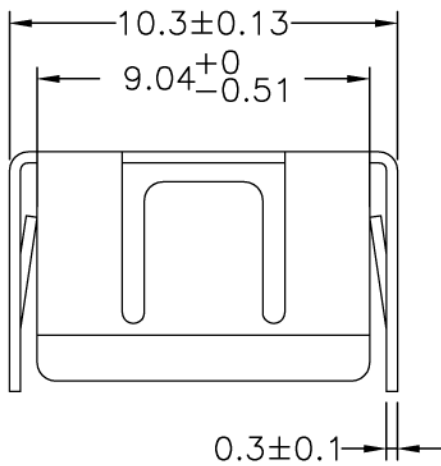
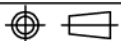

TOLERANCE: .X±0.15 .XX±0.10 .XXX±0.05

UNIT : m / m

SCALE 5 : 1

Finish: 1. Immersion gold on terminal : Thickness gold $0.075 \mu\text{m}$ (3μ inches) min, Base nickel $0.625 \mu\text{m}$ (25μ inches) min.
 2. Immersion Sn on terminal : Terminal: Sn plating, $100, 5 \mu\text{m}$ (200μ inches) min , Base nickel $0.625 \mu\text{m}$ (25μ inches) min.
 3. Coplanarity deviation: 0.10 mm (0.004 inches)max.

REV 2