

LEPCOS (North-West Laboratory)

http://ferrite.ru Tel/fax +7-812-369-11-54

St-Petesburg, Russia

REVISIONS

| REV | SYM | DRAFTER | CHECKER | DATE |
|-----|-----|---------|---------|----------|
| 2 | | T.S.LII | W.H.HSU | 03/12/03 |
| 3 | | T.S.LII | W.H.HSU | 07/24/06 |
| 4 | | T.S.LII | W.H.HSU | 05/16/07 |

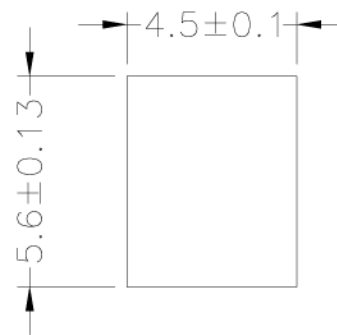
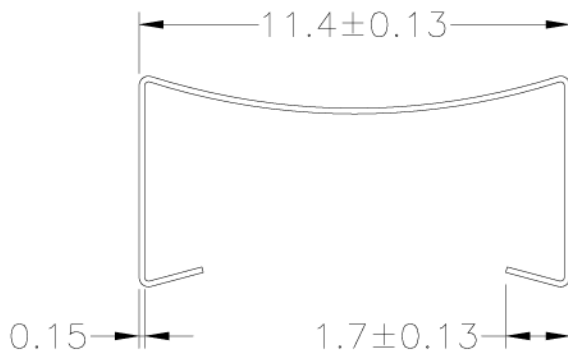
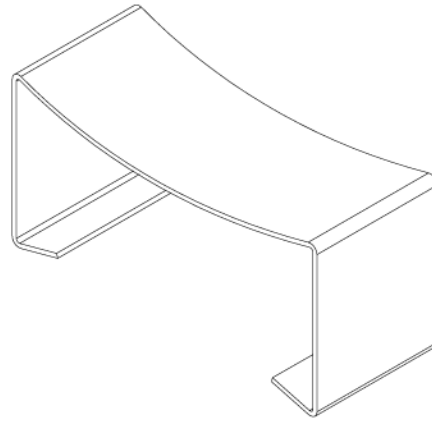

DWG NO. ER11/5 clamp E-009C

| PART NO. | MATERIAL (BOBBIN) | MATERIAL (CLIP) | TERMINAL (PLATING) | PIN ALLOCATION | NOTE |
|----------|-------------------|-----------------|--------------------|----------------|------|
| E-009C | | SUS 301 | | | |

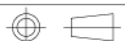

TOLERANCE: .X±0.15 .XX±0.10 .XXX±0.05

UNIT : m / m

SCALE 5 : 1

Finish: 1. Pb wire Immersion Sn on terminal : Thickness:Sn plating,100,5 μm (200 μ inches) min,Base nickel 0.625 μm (25 μ inches) min.
 2. CP wire Immersion Sn on terminal : Thickness:Sn plating,100,5 μm (200 μ inches) min.
 3. Coplanarity deviation: 0.10 mm (0.004 inches)max.

REV 4