

SEC.A-A

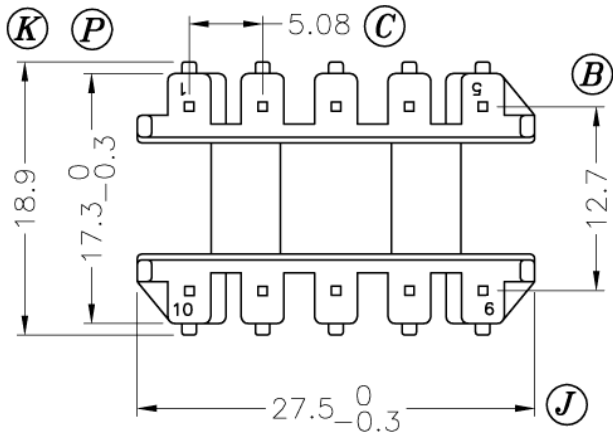
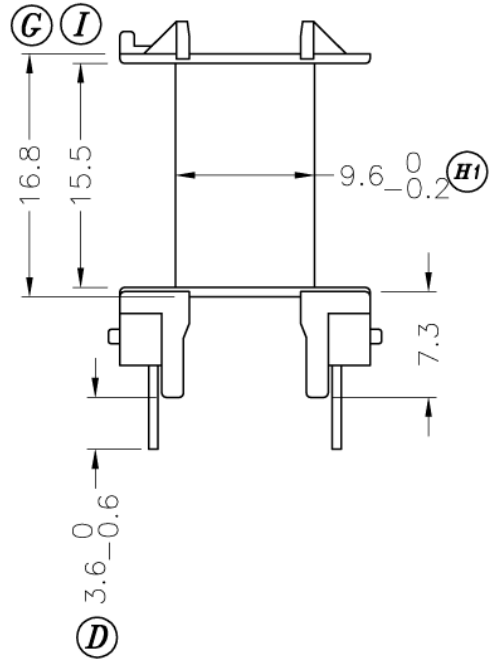
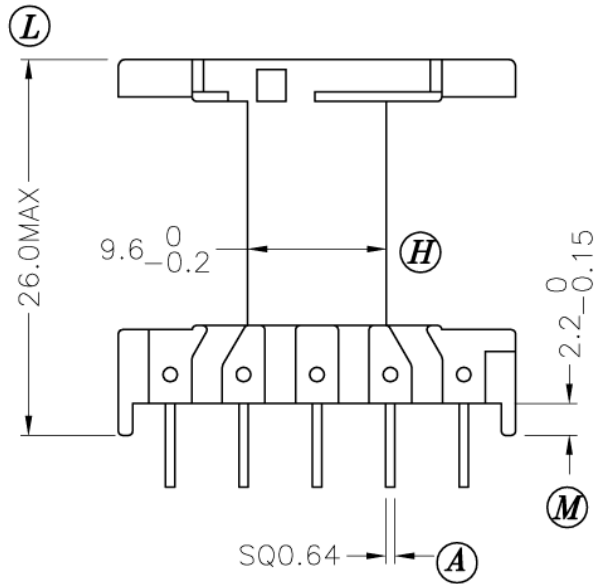

REV.	REVISIONS	REC.	REV.	REVISIONS	REC.

DRAWN & DRAFTED BY	WU FANG	TOLERANCES		ANGLE:	TITLE:		
		0<L≤4 ±0.1	pin pitch ±0.2	±1°	EF-25		UL REC.
CHECKED & APPROVED BY		4<L≤16 ±0.2		UNIT:	BOBBIN MATERIAL:	UL 94V-0	
		16<L≤63 ±0.3	MM	PA66 A3X2G7	PIN TENSION LOAD:		
LEPCOS (NWL) http://ferrite.ru Pin Shine Industrial Co bobbin				ORIGIN:	CP WIRE	1.5KG MIN	
				SZ	DATE:	DRAWING NO.	REV.
					JAN.09 '2003	P-2549	0