

CORE SETS

Effective core parameters

SYMBOL	PARAMETER	VALUE	UNIT
$\Sigma (1/A)$	core factor ( $C_1$ )	2.06	$\text{mm}^{-1}$
$V_e$	effective volume	719.95	$\text{mm}^3$
$l_e$	effective length	38.50	mm
$A_e$	effective area	18.70	$\text{mm}^2$
$W_t$	mass of core	$\approx 4.0$	g

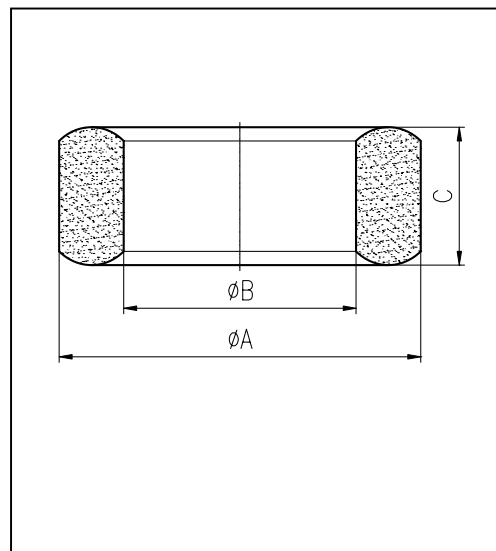

尺寸 Coat	A	B	C
Uncoat	$16.0 \pm 0.3$	$9.6 \pm 0.3$	$6.3 \pm 0.2$
Coated	16.8max	8.9min	7.0max

Note: With grass green epoxy coating

Characteristic

GRADE	AL ( $\text{nH}/\text{N}^2$ )	B (mT)	CORE LOSS (W)
		f=10kHz U=0.25V	H=250A/m f=25kHz T=100°C
DMR40	$1350 \pm 25\%$	$\geq 315$	$\leq 0.45$
DMR44	$1450 \pm 25\%$	$\geq 315$	$\leq 0.42$

GRADE	AL ( $\text{nH}/\text{N}^2$ )	B (mT)	CORE LOSS (W)
		f=10kHz U=0.25V	H=250A/m f=25kHz T=100°C
DMR55	$1200 \pm 25\%$	$\geq 300$	$\leq 0.23$

GRADE	AL ( $\text{nH}/\text{N}^2$ )	$\mu_i$
		f=10kHz U=0.25V
R4K	$2700 \pm 25\%$	$\approx 4300$
R5K	$3350 \pm 25\%$	$\approx 5000$
R7K	$4500 \pm 25\%$	$\approx 7000$
R10K	$6430 \pm 30\%$	$\approx 10000$
R12K	$\geq 4500$	$\approx 12000$