

CORE SETS

Effective core parameters

SYMBOL	PARAMETER	VALUE	UNIT
$\Sigma (1/A)$	core factor (C_1)	0.39	mm^{-1}
V_e	effective volume	5509.7	mm^3
l_e	effective length	46.3	mm
A_e	effective area	119.0	mm^2
A_{min}	minimum area	109.0	mm^2
W_t	mass of core set	≈ 31.4	g

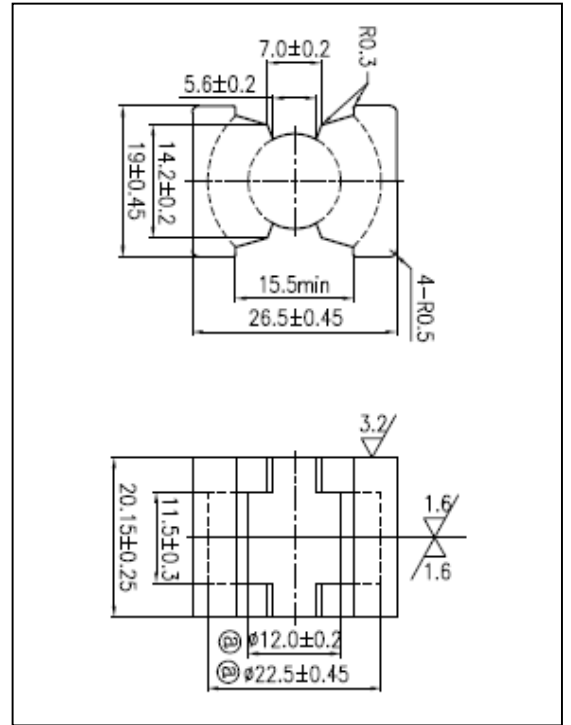

Characteristic

GRADE	AL (nH/N ²)	B (mT)	CORE LOSS (W)	
	f=10kHz U=0.25V	H=250A/m f=25kHz T=100°C	f=100kHz B=200mT T=100°C	
DMR40	5000 ± 25%	≥ 315	≤ 4.40	
DMR44	5000 ± 25%	≥ 315	≤ 3.77	
DMR90	5000 ± 25%	≥ 325	≤ 4.00	
DMR95	6500 ± 25%	≥ 315	≤ 3.30	

GRADE	AL (nH/N ²)	B (mT)	CORE LOSS (W)	
	f=10kHz U=0.25V	H=250A/m f=25kHz T=100°C	f=500kHz B=50mT T=100°C	f=3MHz B=10mT T=100°C
DMR55	5000 ± 25%	≥ 300	≤ 1.76	—
DMR50B	3000 ± 25%	≥ 300	≤ 0.88	—