



H cores

H101×65×15P

CORE SETS

Effective core parameters

SYMBOL	PARAMETER	VALUE	UNIT
$\Sigma (1/A)$	core factor ( $C_1$ )	0.95	$\text{mm}^{-1}$
Ve	effective volume	67032.00	$\text{mm}^3$
le	effective length	252.00	mm
Ae	effective area	266.00	$\text{mm}^2$
Wt	mass of core	$\approx 337.9$	g

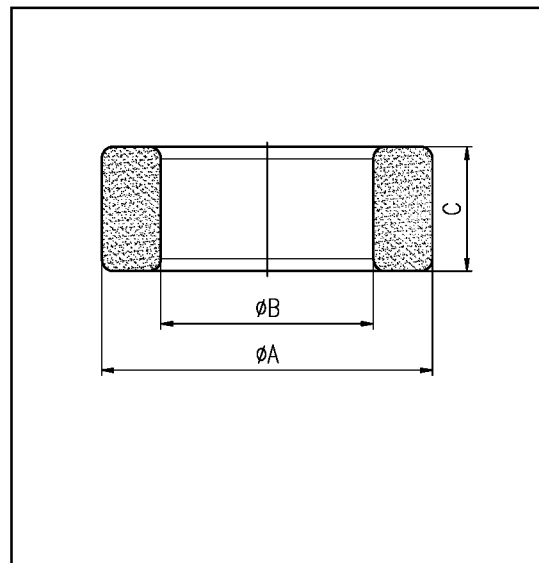

尺寸	A	B	C
Coat			
Uncoat	$101.0 \pm 2.0$	$65.0 \pm 1.5$	$15.0 \pm 1.5$
Coated	104.2max	62.5min	17.5max

Note: With grass green epoxy coating

Characteristic

GRADE	AL ( $\text{nH/N}^2$ )	B (mT)	CORE LOSS (W)
	f=10kHz U=0.25V	H=250A/m f=25kHz T=100°C	f=100kHz B=200mT T=100°C
DMR40	$3040 \pm 25\%$	$\geq 320$	$\leq 40.55$
DMR44	$3040 \pm 25\%$	$\geq 320$	$\leq 39.30$

GRADE	AL ( $\text{nH/N}^2$ )	$\mu_i$
	f=10kHz U=0.25V	f=10kHz U=0.25V
R5K	$6000 \pm 25\%$	$\approx 5000$
R7K	$7900 \pm 25\%$	$\approx 7000$
R10K	$\geq 7500$	$\approx 10000$
R12K	$\geq 8200$	$\approx 12000$