

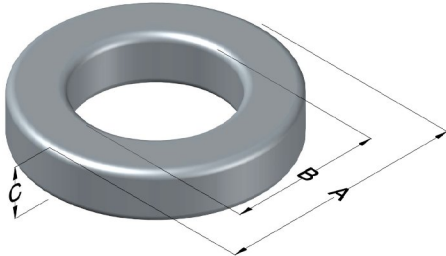

**C055348A2**

110 Delta Drive  
 Pittsburgh, PA 15238  
 NAFTA Sales: (1)800-245-3984  
 HK Sales : (852)3102-9337  
 magnetics@spang.com  
 www.mag-inc.com



MPP Permeability ( $\mu$ )	$A_L$ (nH/T <sup>2</sup> )	Core Marking			Coating Color
		Lot Number	Part Number	Inductance Grade	
160	135 $\pm$ 8%	XXXXXX	55348A2	X	Gray

Dimensions	Uncoated		Coated Limits			Packaging
	(mm)	(in)	(mm)	(in)		
OD (A)	23.6	0.928	24.4	0.958	max	Cardboard cut-outs Box Qty= 480 pcs
ID (B)	14.4	0.567	13.7	0.542	min	
HT (C)	8.89	0.350	9.66	0.380	max	

Electrical Characteristics			Physical Characteristics						
Watt Loss @ 100 kHz, 100mT max(mW/cm <sup>3</sup> )	DC Bias min (A-T/cm)		Voltage Breakdown wire to wire min (V <sub>AC</sub> )	Break Strength min (kg)	Window Area W <sub>A</sub> (mm <sup>2</sup> )	Cross Section A <sub>e</sub> (mm <sup>2</sup> )	Path Length L <sub>e</sub> (mm)	Volume V <sub>e</sub> (mm <sup>3</sup> )	Weight (g)
	80%	50%							
950	16.6	31.0	1000	29	149	38.8	58.8	2,280	20

Winding Information					Temperature Rating	
Winding Length Per Turn				Wound Coil Dimensions (mm)		Curie Temp: 460 °C
Winding Factor	(mm)	Winding Factor	(mm)	Maximum OD (70%)	33.5	Coating Temp (Continuous up to): 200 °C
				Maximum HT (70%)	21.4	
0%	29.8	40%	36.9	Surface Area (mm <sup>2</sup> )		Notes:
20%	33.4	45%	38.0	Unwound Core		
25%	34.2	50%	38.9	40% Winding Factor		
30%	35.0	60%	41.1			
35%	36.1	70%	43.6			

**Typical DC Bias Performance**

